

NON-RESIDENTIAL ENTRY DOORS



NON-RESIDENTIAL ENTRY DOORS

————— STANDARD DUTY • LIGHT DUTY —————

THE PROFESSIONAL WAY

ProVia® has developed a competitive position by catering to a niche market that demands a high degree of customization coupled with superior quality. You will find attention to detail is what our customers have come to appreciate and expect from us. We're building your windows and our company to **last a lifetime - it's The Professional Way!**

We've been building a reputation for quality since our company was founded over 40 years ago near Sugarcreek, Ohio, in the heart of Amish country, an area well known for quality and craftsmanship. While old-world craftsmanship is very much a part of our culture, it's supported by modern design techniques and state-of-the-art manufacturing processes. We've created the perfect balance between traditional quality and modern technology.

CUSTOM CAPABILITIES

The materials, as well as the workmanship, give our custom made doors their exceptional quality and durability, far exceeding what is available in a ready-made door. Unlike consumer grade doors, professional-class doors are customized to your exact measurements for a better fit and a more secure and energy efficient door.

Entry Systems custom tailored for you.

**11
TIME**

Partner of the
Year Award



90%+ of Windows and Doors
are ENERGY STAR®
Certified

40+ Professional-Class
Exterior Building
Product Lines

DOORS | WINDOWS | SIDING | STONE | ROOFING



6 Facilities in the United States

900+

Associates Nationwide

Our Mission:

— TO SERVE, BY CARING FOR —
DETAILS
IN WAYS OTHERS WON'T

Doing Business Since

1977

19

Core Values

200+

Metric Tons of CO²
Saved Annually

1,900+

Tons of metals, paper, glass and vinyl
recycled annually at ProVia facilities

Visit provia.com to explore all of our products and options or
download the app.



ENVIRONMENTAL STEWARDSHIP

ProVia®'s ENERGY STAR® certified doors and windows are independently tested and certified to meet strict energy-efficiency standards set by the Environmental Protection Agency. The EPA has awarded ProVia twelve times, four for Partner of the Year, seven for Partner of the Year – Sustained Excellence, and once for Excellence in Promotion for our outstanding efforts to promote and educate our communities on the importance of saving energy.



At ProVia, not only do we manufacture energy efficient products, but we also exercise corporate environmental stewardship. Here are a few examples:

- We use Honeywell's fourth generation Solstice® Liquid Blowing Agent that was formulated to be nonflammable while significantly lowering global warming potential and improve energy efficiency.
- We recycle paper, metals and glass.
- Solar energy panels are being used at three production facilities as part of the company's effort to lower energy costs.
- Our Pollution Prevention Program dramatically reduced solvent usage.
- To save fuel, our trucks use the TriPac™ Idle Reduction and Temperature Management System.
- Paperless online ordering and internal paperless fax system reduces paper usage.



For more information, visit the Environmental Stewardship section of our website at: provia.com/esproducts

STEEL DOORS

DOOR STYLES

Our steel door features add up to a professional-class product. Whether you select Woodgrain Textured Steel or Smooth Steel, our entry systems will provide an elegant, durable and energy efficient entryway.

CUSTOM WIDTHS & HEIGHTS

Need a little more height or a little less width? We are pleased to offer customized door widths and heights in 1/8" increments.

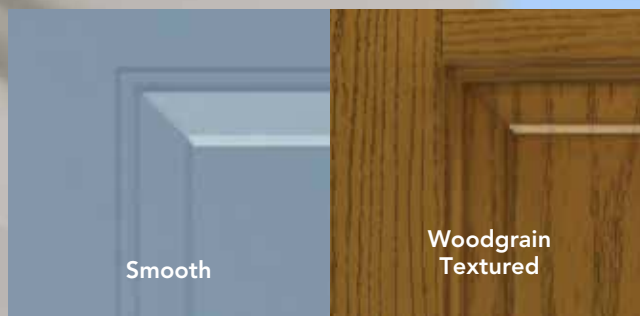

DOOR STYLES

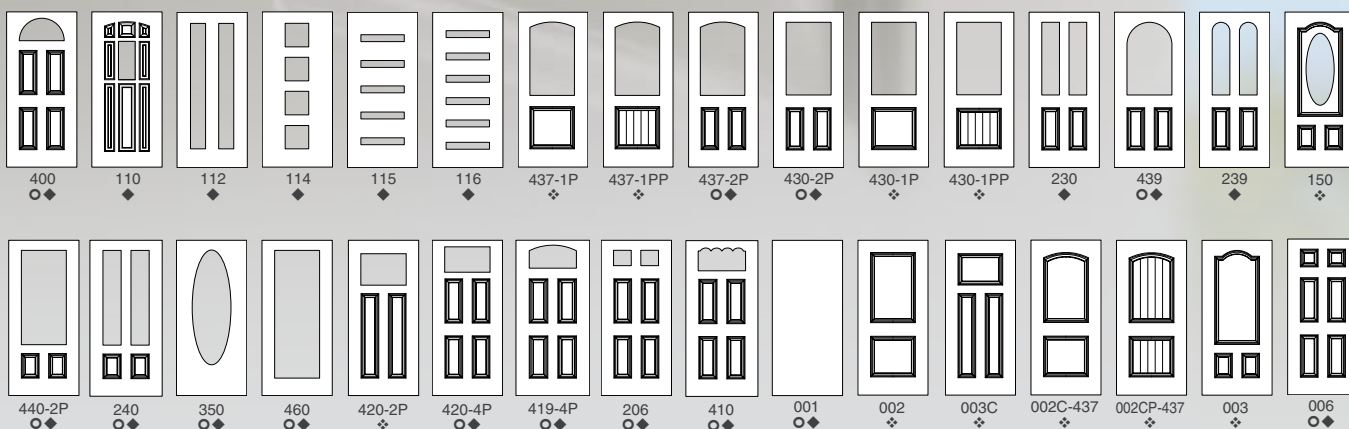

8' DOORS

8' SIDELITES

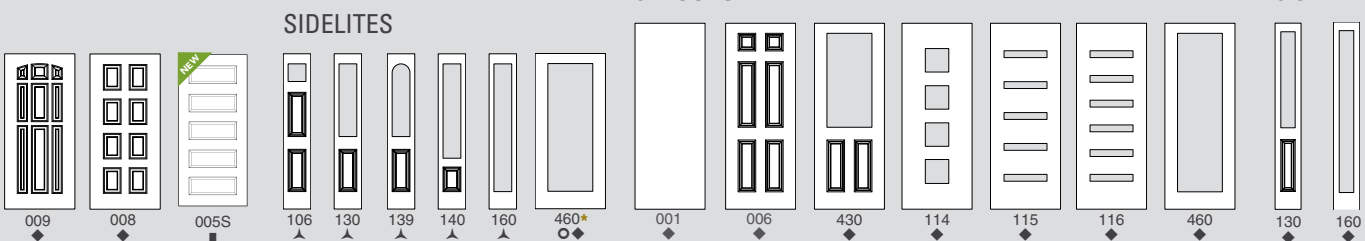

- 20-gauge Woodgrain Textured Steel
- ◆ 20-gauge Smooth Steel
- ❖ 20-gauge Smooth Steel with High-Definition Embossing
- ▲ 24-gauge Smooth or Textured Steel (used with all 20-gauge doors)
- 20-gauge smooth shaker

† Patent - USD621062

STEEL DOOR ADVANTAGES

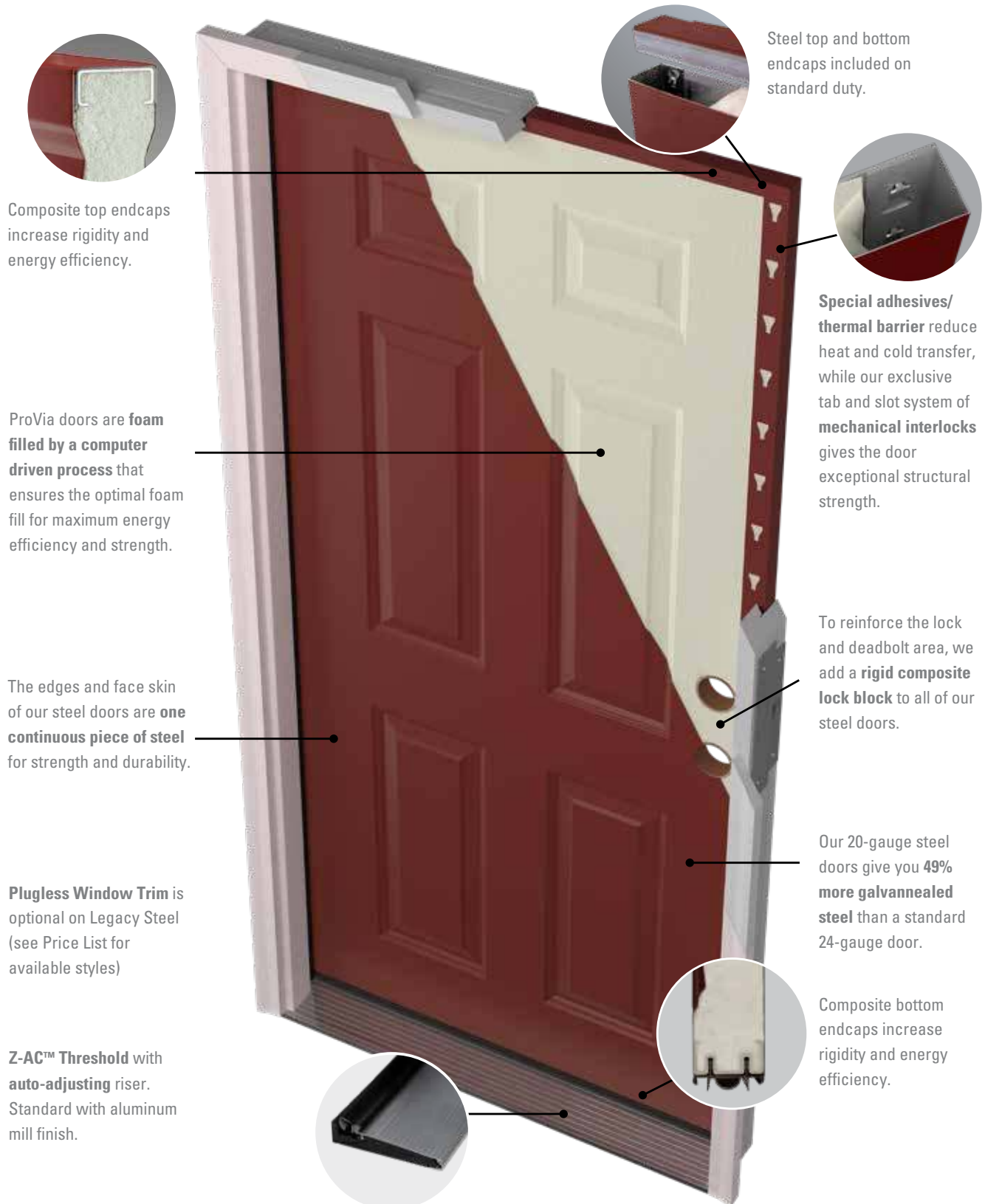

Composite top endcaps increase rigidity and energy efficiency.

ProVia doors are **foam filled by a computer driven process** that ensures the optimal foam fill for maximum energy efficiency and strength.

The edges and face skin of our steel doors are **one continuous piece of steel** for strength and durability.

Plugless Window Trim is optional on Legacy Steel (see Price List for available styles)

Z-AC™ Threshold with **auto-adjusting** riser. Standard with aluminum mill finish.

Steel top and bottom endcaps included on standard duty.

Special adhesives/thermal barrier reduce heat and cold transfer, while our exclusive tab and slot system of **mechanical interlocks** gives the door exceptional structural strength.

To reinforce the lock and deadbolt area, we add a **rigid composite lock block** to all of our steel doors.

Our 20-gauge steel doors give you **49% more galvanized steel** than a standard 24-gauge door.

Composite bottom endcaps increase rigidity and energy efficiency.

STEEL DOORS

20-GAUGE STEEL ENTRY DOORS - STANDARD DUTY

20-GAUGE SMOOTH & TEXTURED STEEL

- Energy Efficient Polyurethane Foam Core
- Architecturally Correct Woodgrain Texture (Textured Steel Only)
- Clean Elegant Smooth Look
- Strong Mechanical Tab and Slot Construction
- Energy Efficient Weatherstripping
- Factory Pre-Finishing is Available

STEEL DOOR TESTING

Doors have been tested and certified to NFRC (National Fenestration Rating Council) 100 and NFRC 200 guidelines enabling the ENERGY STAR Thermal Performance Qualification.

PHYSICAL ENDURANCE TEST

Test Performed: In-House SDI 131 Physical Endurance Test
Result: Level A, 1,000,000

IMPACT TEST

Test Performed: In-House ASTM F476 Forced Entry Test
Result: Maximum Security Level of 40

ACOUSTICAL PERFORMANCE TEST

Test Performed: ASTM E90
Result: Sound Transmission Class (STC) 23

FIRE RESISTANCE TEST

Test Performed: CAN4 S 104, UL 10C, NFPA 252
Result: 90 Minute Positive Pressure with Hose Stream with 16-Gauge Steel Frame

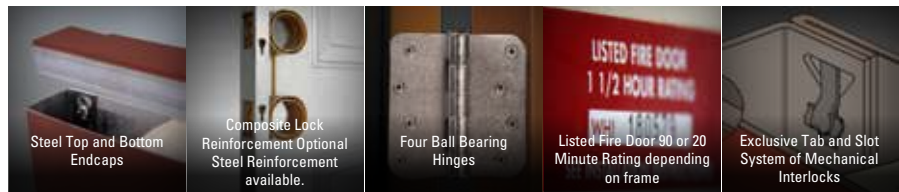

STEEL DOOR STANDARD SPECIFICATIONS

Standard duty; 20-gauge (0.032") faces

FACE MATERIAL

Galvanized steel shall comply with ASTM A 653 and A 924

DOOR TOP & BOTTOM REINFORCEMENTS

Steel Top and Bottom Endcaps

HINGE REINFORCEMENTS

With closer 10 Gauge
Without closer 20 Gauge

HINGES

Four ball bearing hinges

LOCKSET & DEADBOLT REINFORCEMENTS

Minimum thickness of .067" (16-gauge). Thread formed to be the equivalent to 14-gauge.

DOOR CORE

Polyurethane foam filled and fully bonded to face sheets. Total product U-factor as low as 0.21.

FRAME

4 $\frac{1}{8}$ " Full Wood Frame

THRESHOLD

Aluminum Threshold

PAINT

1 color both sides (inside frame painted to match)

WINDOW TRIM

Standard (where applicable)

CLOSER REINFORCEMENT

14-Gauge

STRIKE LOCATION

42" - 6" Center-to-Center

ADDITIONAL AVAILABLE OPTIONS

- Hardware Prep
- Facebore
- 16-Gauge Rim Lock Box
- 16-Gauge Mortise Lock Box
- 14-Gauge Panic Reinforcement
- Panic Hardware Available
- Edge Preps 1"x 2 $\frac{1}{4}$ ", 1 $\frac{1}{8}$ " x 2 $\frac{1}{4}$ ", 1 $\frac{1}{4}$ " x 8"
- No Face Prep
- Mortise Face Prep
- 1 $\frac{1}{8}$ " or 2 $\frac{1}{8}$ " Cylindrical Lockset Facepreps
- Strike Plate Preps: 2 $\frac{1}{4}$ " or 4 $\frac{1}{8}$ "
- 20 or 90 Minute Fire Rating

- 16-Gauge Hollow Metal Masonry Frame
- 16-Gauge Hollow Metal Drywall Frame
- Threshold Options: No Threshold, Saddle Threshold, ADA Compliant Threshold
- All Glass Styles + Laminated Glass with Cellular PVC Trim, Laminated Glass with Aluminum Trim, Fire Rated Glass and Trim (up to 100 in²)

20-GAUGE STEEL ENTRY DOORS - LIGHT DUTY



20-GAUGE SMOOTH & TEXTURED STEEL

- Energy Efficient Polyurethane Foam Core
- Architecturally Correct Woodgrain Texture (Textured Steel Only)
- Clean Elegant Smooth Look
- Strong Mechanical Tab and Slot Construction

STEEL DOOR TESTING

Doors have been tested and certified to NFRC (National Fenestration Rating Council) 100 and NFRC 200 guidelines enabling the ENERGY STAR Thermal Performance Qualification.

PHYSICAL ENDURANCE TEST

Test Performed: In-House SDI 131 Physical Endurance Test

Result: Level A, 1,000,000

IMPACT TEST

Test Performed: In-House ASTM F476 Forced Entry Test

Result: Maximum Security Level of 40

ACOUSTICAL PERFORMANCE TEST

Test Performed: ASTM E90

Result: Sound Transmission Class (STC) 23

FIRE RESISTANCE TEST

Test Performed: CAN4 S 104, UL 10C, NFPA 252

Result: 90 Minute Positive Pressure with Hose Stream with 18-Gauge Steel Frame

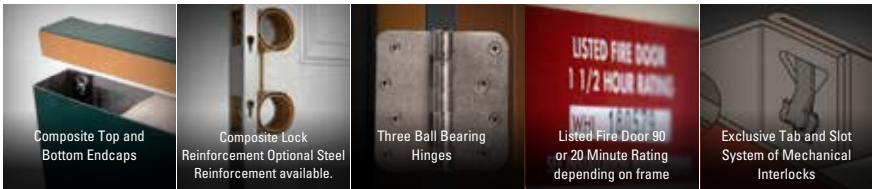

STEEL DOOR STANDARD SPECIFICATIONS

Light duty, 20-gauge (0.032") faces

FACE MATERIAL

Galvannealed steel shall comply with ASTM A 653 & A 924

DOOR TOP & BOTTOM REINFORCEMENTS

Fiberglass Channels (For fire rated doors, or doors with closers, Steel Channels are used)

HINGE REINFORCEMENTS

With closer 10 Gauge
Without closer 20 Gauge

HINGES

Three ball bearing hinges (optional 4th ball bearing hinge available)

DOOR CORE

Polyurethane foam filled and fully bonded to face sheets.
Total product U-factor as low as 0.21.

FRAME

4 $\frac{1}{8}$ " Full Wood Frame

THRESHOLD

Z-AC™ Threshold Aluminum Mill Finish

PAINT

1 color both sides

WINDOW TRIM

Standard (where applicable)

EDGE PREP

1" x 2 $\frac{1}{4}$ "

LOCKSET & DEADBOLT STRIKE PLATE PREP

Standard (34 $\frac{3}{4}$ ") (2 $\frac{1}{4}$ ") 5 $\frac{1}{2}$ " Center-to-Center

LOCKSET

Schlage F51N Georgian Knob

DEADBOLT

Schlage B60 Thumbturn (Grade 1)

HARDWARE REINFORCEMENT

Composite Lock Block

ADDITIONAL AVAILABLE OPTIONS

- 16-Gauge Rim Lock Box
- 16-Gauge Mortise Lock Box
- No Edge Prep
- No Face Prep
- 14-Gauge Closer Reinforcement
- Mortise Lock Box
- Edge Preps 1 $\frac{1}{2}$ " x 2 $\frac{1}{4}$ ", or 1 $\frac{1}{4}$ " x 8" or Trilennium
- Mortise Face Prep
- 1 $\frac{1}{2}$ " or 2 $\frac{1}{2}$ " Cylindrical Lockset Facepreps
- 2 $\frac{1}{2}$ " Cylindrical Deadbolt Face Prep
- 4 $\frac{1}{2}$ " Strike Plate Prep
- 20 or 90 Minute Fire Rating
- 18-Gauge Hollow Metal Masonry Frame
- 18-Gauge Hollow Metal Drywall Frame
- 18-Gauge Redi-Flex Adjustable Steel Frame
- Threshold Options: No Threshold, Saddle Threshold, ADA Compliant Threshold
- All Glass Styles + Laminated Glass with Standard Trim, Laminated Glass with Aluminum Trim, Fire Rated Glass and Trim (up to 100 in²)
- Cylindrical Commercial Hardware and Preps

REINFORCEMENT OPTIONS

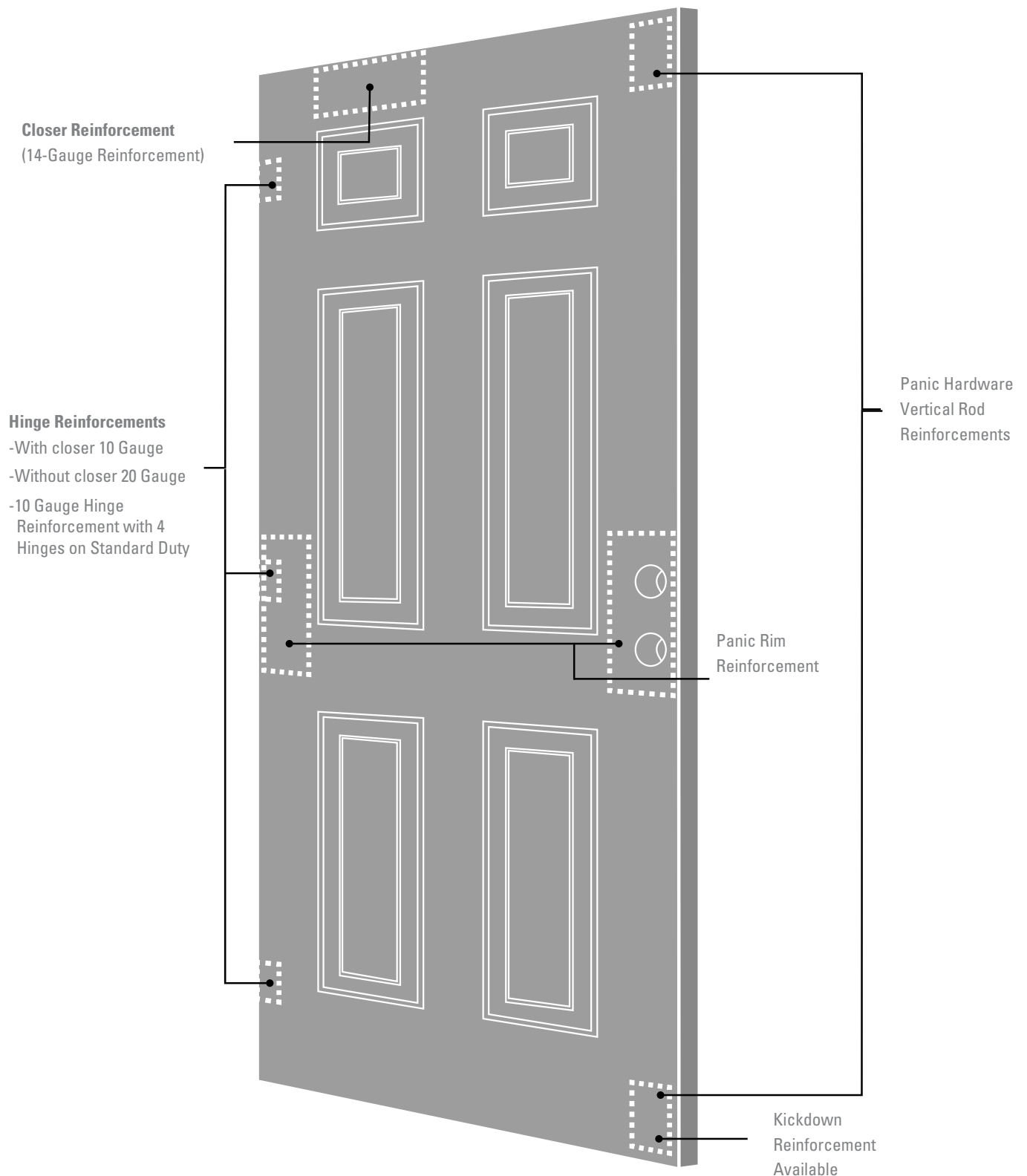



Shown With Panic Rim
Device, QDC312 Closer
and Kickdown

FIBERGLASS DOORS

DOOR STYLES

Our Fiberglass doors are available in Cherry, Mahogany, Oak, Fir and Smooth Series. Structurally, our door is far superior to traditional fiberglass doors with robust hardwood stiles and rails dovetailed at each corner. All fiberglass doors exhibit our exclusive DuraFuse™ finishing system featuring P³ Fusion which gives our doors lasting finish durability.

CUSTOM WIDTHS & HEIGHTS

Need a little more height or a little less width? We are pleased to offer customized door widths and heights in 1/8" increments.

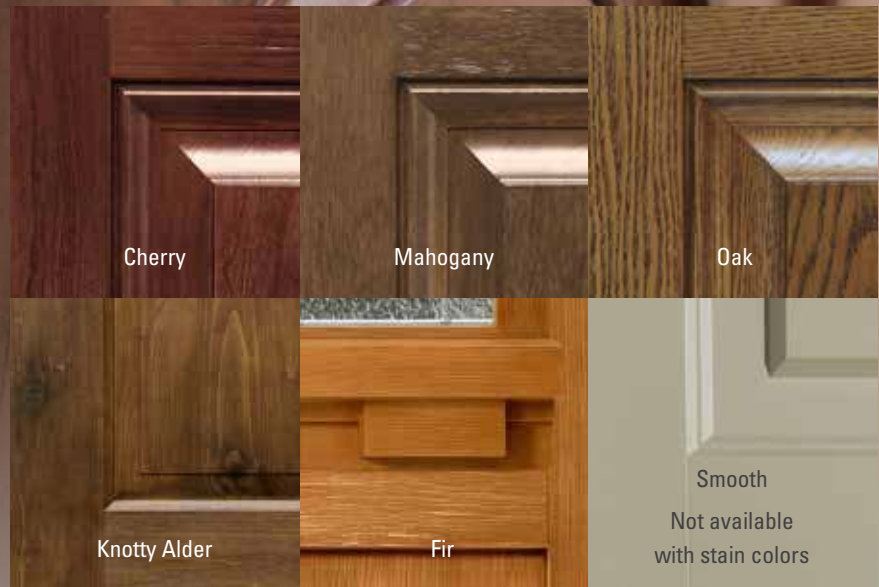

See page 22 for Fiberglass paint and stain finishes.

DOOR STYLES

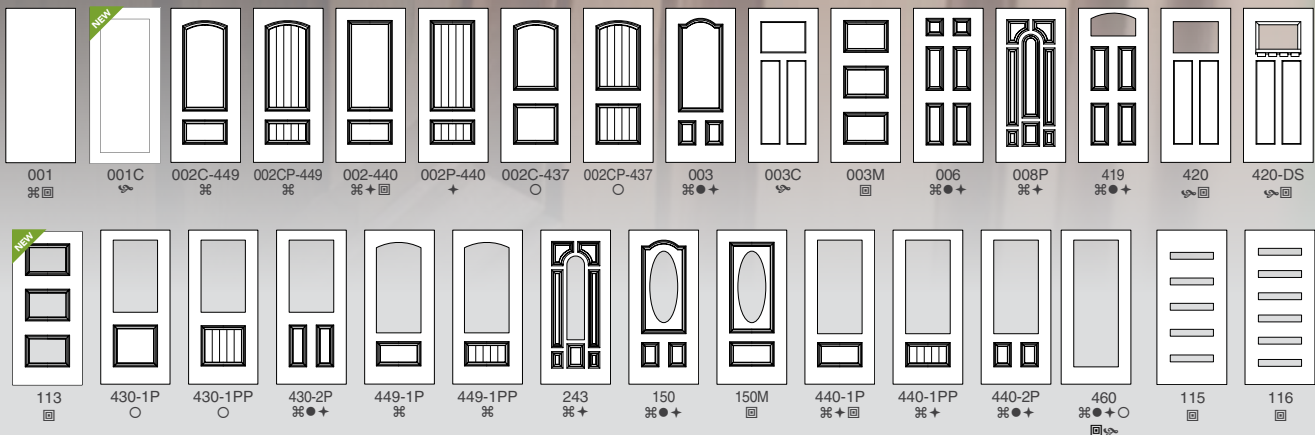

8' Doors

Not available as French Doors

Sidelite Styles

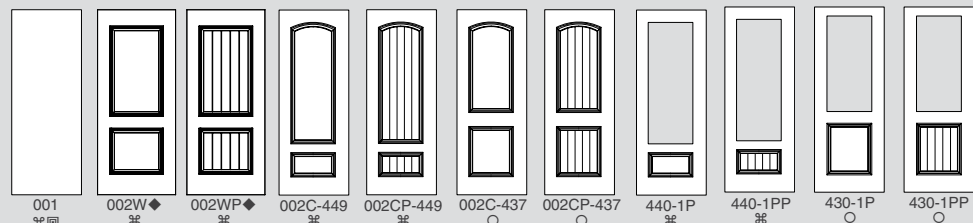
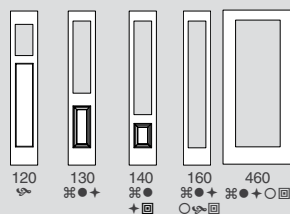

8' Sidelite

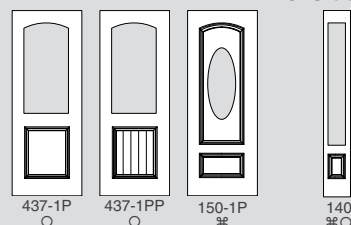

- ☞ Cherry Series
- Mahogany Series
- + Oak Series
- Knotty Alder Series
- ☞ Fir Series
- ☞ Smooth Series
- ◆ Only available in 42" x 96" size

FIBERGLASS ADVANTAGES



FIBERGLASS ENTRY DOORS

STANDARD DUTY



FIBERGLASS

- Realistic Woodgrain Appearance from nickel vapor deposition technology
- Energy Efficient Polyurethane Foam Core
- Architecturally Correct Woodgrain Texture
- Strong Solid Wood Perimeter Frame
- Z-AC™ is Standard
- Energy Efficient Weatherstripping
- Factory Pre-Finished
- DuraFuse Finishing System Featuring P³ Fusion

FIBERGLASS DOOR TESTING

Doors have been tested and certified to NFRC (National Fenestration Rating Council) 100 and NFRC 200 guidelines enabling the ENERGY STAR Thermal Performance Qualification.

FORCED ENTRY TEST

Test Performed: ASTM F476 Forced Entry Test
Result: Maximum Security Level of 40

WIND LOAD RATING TEST

Test Performed: ASTM E330-97 Structural Performance
Result: DP (Design Pressure) = ±55 psf for 3' 0" x 6' 8" Opaque Inswing Door

ACOUSTICAL PERFORMANCE TEST

Test Performed: ASTM E90
Result: STC=26 Standard Opaque Door

FIRE RESISTANCE TEST

Test Performed: NFPA 252, CAN4 S 104, UL10C
Result: 20 Minute Category A, Positive Pressure with Category C Frame



4 1/2" Finger-jointed
4-ply hardwood hinge and
strike stile



Stiles and rails are dovetailed
and glued at each corner

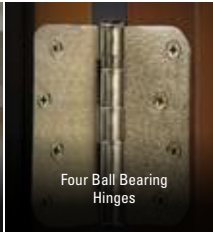

Four Ball Bearing
Hinges

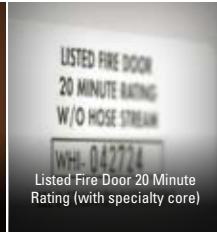

Listed Fire Door 20 Minute
Rating (with specialty core)

FIBERGLASS DOOR STANDARD SPECIFICATIONS

Fiberglass Slab with High Definition Woodgrain Face

FRAME

4 5/8" Full Wood Frame

DOOR TOP & BOTTOM REINFORCEMENTS

Poplar Top Rail & Composite Bottom Rail

PERIMETER

4-Ply, Finger-Jointed Solid Wood

DOOR EDGES

Door edges of Cherry, Oak, Mahogany and Fir

DOOR CORE

Polyurethane Core: Foamed in place polyurethane with a U-factor as low as .16

HINGES

Four Ball Bearing Hinges

HARDWARE

None

FACEBORE/EDGE PREP

None

WARRANTY

Non-Residential Warranty

PAINT

1 color both sides (inside frame painted to match)

WINDOW TRIM

Standard (where applicable)

STRIKE LOCATION

42"

LOCKSET & DEADBOLT PREP

6" Center to Center

ADDITIONAL AVAILABLE OPTIONS:

- Wood Closer Reinforcement
- Wood Panic Reinforcement
- Panic Hardware Available
- 4 1/4" panic bar reinforcement
- Mortise Face Prep
- Edge Preps 1" x 2 1/4", 1 1/8" x 2 1/4", 1 1/4" x 8"
- 2 1/8" Cylindrical Deadbolt Facepreps
- 1 1/8" or 2 1/8" Cylindrical Lockset Facepreps
- Strike Plate Preps: 2 1/4" or 4 1/8"
- 20 Minute Fire Rating
- 16-Gauge Hollow Metal Masonry Frame
- 16-Gauge Hollow Metal Drywall Frame
- Threshold Options: No Threshold, Saddle Threshold, ADA Compliant Threshold
- All Glass Styles

FIBERGLASS ENTRY DOORS

LIGHT DUTY

FIBERGLASS

- Realistic Woodgrain Appearance from nickel vapor deposition technology
- Energy Efficient Polyurethane Foam Core
- Architecturally Correct Woodgrain Texture
- Strong Solid Wood Perimeter Frame
- Z-AC™ Threshold is Standard
- Energy Efficient Weatherstripping
- Factory Pre-Finished
- DuraFuse Finishing System Featuring P³ Fusion

FIBERGLASS DOOR TESTING

Doors have been tested and certified to NFRC (National Fenestration Rating Council) 100 and NFRC 200 guidelines enabling the ENERGY STAR Thermal Performance Qualification.

FORCED ENTRY TEST

Test Performed: ASTM F476 Forced Entry Test

Result: Maximum Security Level of 40

WIND LOAD RATING TEST

Test Performed: ASTM E330-97 Structural Performance

Result: DP (Design Pressure) = ±55 psf for 3' 0" x 6' 8" Opaque Inswing Door

ACOUSTICAL PERFORMANCE TEST

Test Performed: ASTM E90

Result: STC=26 Standard Opaque Door

FIRE RESISTANCE TEST

Test Performed: NFPA 252, CAN4 S 104, UL10C

Result: 20 Minute Category A, Positive Pressure with Category C Frame



2 1/4" Finger-jointed 3-ply hardwood hinge stile

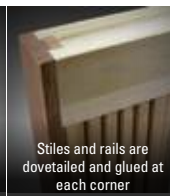

Stiles and rails are dovetailed and glued at each corner

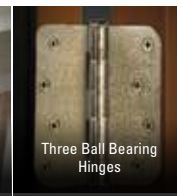

Three Ball Bearing Hinges

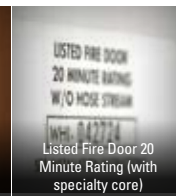

Listed Fire Door 20 Minute Rating (with specialty core)

FIBERGLASS DOOR STANDARD SPECIFICATIONS

Fiberglass Slab with High Definition Woodgrain Face

FRAME

4 5/8" Full Wood Frame

DOOR TOP & BOTTOM REINFORCEMENTS

Poplar Top Rail & Composite Bottom Rail

PERIMETER

4-Ply, Finger-Jointed Solid Wood (Strike Side)

3-Ply, Finger-Jointed Solid Wood (Hinge Side)

DOOR EDGES

Door edges of Cherry, Oak, Mahogany and Fir

DOOR CORE

Polyurethane Core: Foamed in place polyurethane with a U-factor as low as .16

HINGES

Three Ball Bearing Hinges

THRESHOLD

Z-AC™ Threshold Anodized Bronze Finish

HARDWARE

None

EDGE PREP

1" x 2 1/4"

WARRANTY

Non-Residential Warranty

PAINT

1 color both sides (inside frame painted to match)

WINDOW TRIM

Standard (where applicable)

STRIKE LOCATION

34 3/4"

LOCKSET & DEADBOLT PREP

5 1/2" Center to Center

ADDITIONAL AVAILABLE OPTIONS:

- Wood Closer Reinforcement
- No Face Prep
- Mortise Face Prep
- No Edge Preps
- 2 1/2" Cylindrical Deadbolt Facepreps
- 1 1/2" or 2 1/2" Cylindrical Lockset Facepreps
- Strike Plate Preps: 2 1/4" or 4 3/8"
- 20 Minute Fire Rating
- Edge Preps 1 1/2" x 2 1/4", or 1 1/4" x 8" or Trilennium
- 18-Gauge Hollow Metal Masonry Frame
- 18-Gauge Hollow Metal Drywall Frame
- 18-Gauge Redi-Flex Adjustable Steel Frame
- Threshold Options: No Threshold, Saddle Threshold, ADA Compliant Threshold
- All Glass Styles

FULL WOOD FRAME

LIGHT DUTY AND STANDARD DUTY

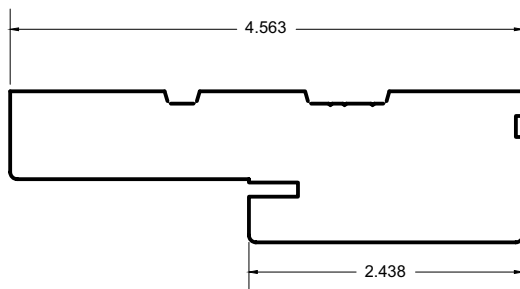

- Available In Custom Frame Depths
- 20-Gauge Steel Security Plate at Strike Area
- Endgrain is Treated to prevent rotting

FRAMESAVER®



Shrinking and swelling occur from changes in relative humidity in the atmosphere. **Water wicks** up through wood fibers resulting in **paint peeling, rot and mold**. Traditional door frames begin to rot within 3-6 months of field installation.

Our **finger-jointed composite bottom** never absorbs water, warps, cracks or rots, and paints and finishes just like wood. Plus, FrameSaver is backed by the industry's only **fully-transferable lifetime limited warranty** for ultimate peace of mind.

FRAME CLADDING OPTION

- PVC Coated Aluminum Cladding
- Match Most of Our Paint Colors
- Pre-Fitted for Custom Frame Depths
- Completely Maintenance Free Exterior
- No Follow-Up Painting is Required
- Now Also Available in Four Smooth Cladding Colors.



COMPOSITE FRAME OPTION

Our Composite door frame system option combines all the strength and convenience of wood with enhanced properties that make it moisture and insect resistant. Composite frame will not absorb or wick moisture and will never rot or splinter.

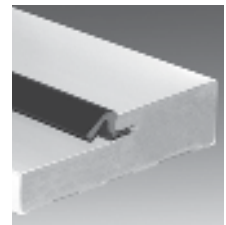

- Smooth white finish (inside frame rabbet is painted to match inside door color)
- Standard 4 $\frac{3}{8}$ " frame depth
- Available for steel or fiberglass doors
- Available for Single doors, French doors, Sidelites and Rectangle Transoms
- Standard Brickmold, Brickmold with Nailing Fin, 3 $\frac{1}{2}$ " Flat Brickmold, 5 $\frac{1}{2}$ " Flat or Custom Width Flat Brickmold up to 5 $\frac{1}{2}$ "†
- Frame Extensions from 4 $\frac{3}{4}$ " up to 12 $\frac{1}{8}$ "
- Custom Mullion Build-Up between door and sidelite†

† Requires cladding for the entire unit.

Full Wood Frame

Rough Opening Sizes				
	20-Gauge Steel Standard Duty	20-Gauge Steel Light Duty	Fiberglass Standard Duty	Fiberglass Light Duty
36" x 80" Single Door Width x Height	38" x 82"	38" x 82"	38" x 82"	38" x 82"
36" x 80" With One 12" Sidelite Combo Door Width x Height	51 $\frac{1}{8}$ " x 82"	51 $\frac{1}{8}$ " x 82"	51 $\frac{1}{8}$ " x 82"	51 $\frac{1}{8}$ " x 82"

REDI-FLEX® ADJUSTABLE STEEL FRAME

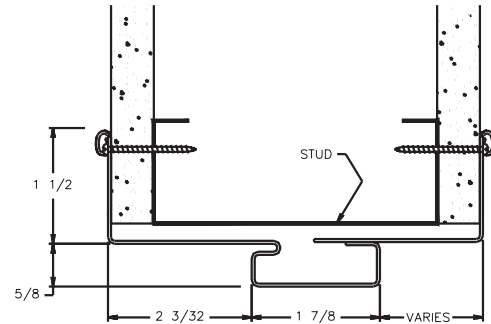

- Adjustable Throat Frame Designed for Prehang Applications
- 4½" to 12½" wall sizes (1" adjustment). Wall thickness greater than 7½" will be special order.
- ⅝" Stop Height
- Standard Frame is Cold-Rolled Steel per ASTM A366
- Prepped with Anchoring Holes with Vision Slot for Wood Casing
- 90 Minute Positive Pressure Fire Rating
- S56 Steel Colonial Casing, Aluminum Casing, or Steel Casing Prep Optional
- Accommodates Non-standard Wall Size
- Also Available With Panic Rim Hardware

18-gauge trim piece.
Available for walls 4½" to
12½" in 1" increments.
Wall thickness greater than 7½"
will be special order.



Standard sill - no
notching required

Redi-Flex Adjustable Steel Frame

Rough Opening Sizes				
	20-Gauge Steel Standard Duty	20-Gauge Steel Light Duty	Fiberglass Standard Duty	Fiberglass Light Duty
32" x 80" Single Door Width x Height	N/A	33 x 81⅝"	N/A	33 x 81⅝"
36" x 80" Single Door Width x Height	N/A	37 x 81⅝"	N/A	37 x 81⅝"

INSTALLATION FRAMES

STEEL FRAMES

16-GAUGE HOLLOW METAL MASONRY FRAME

(STANDARD DUTY - 4 HINGES)



WIDTH

Nominal Door Width	Rough Opening Width
30"	34 $\frac{1}{8}$ "
32"	36 $\frac{1}{8}$ "
34"	38 $\frac{1}{8}$ "
36"	40 $\frac{1}{8}$ "
42"	46 $\frac{1}{8}$ "
60"	64 $\frac{1}{4}$ "
64"	68 $\frac{1}{4}$ "
72"	76 $\frac{1}{4}$ "

HEIGHT

Nominal Door Height	Rough Opening Height
80"	82 $\frac{1}{4}$ "
84"	86 $\frac{1}{4}$ "

- 16-Gauge, A40 Galvanized Steel Construction
- Knock-Down Design
- 18-Gauge Corner Reinforcements to Maintain Proper Miter Alignment
- Welded-In Expansion Bolt Anchors for Masonry Frames

- Built-in Strike Mortised Boxes
- Tab and Slot Construction
- 16-Gauge Frames Have Four Hinges
- Strike Jamb Mortised and Reinforced with 18-Gauge Welded-in Reinforcements

- 12-Gauge Hinge Reinforcements on 4" Hinges
- Pre-Finished to Match Door Slab (optional)
- Simple Labor Installation
- Kerfed Stop with Q-Lon Weatherstripping
- Saddle Threshold

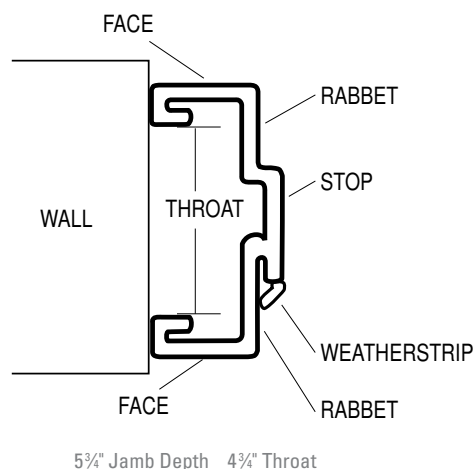

FRENCH DOORS

COMMERCIAL BYPASS ASTRAGAL WITH OPTIONAL REMOVABLE MULLION

(Also available with 16-Gauge Drywall Frame)

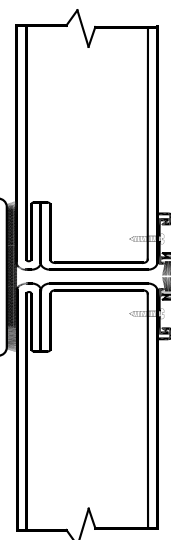
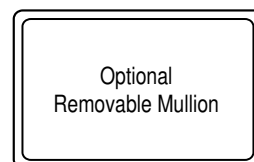

ANCHORS

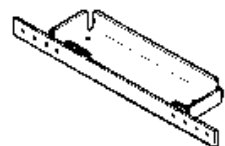

Wood or Metal Stud Anchor



Dynabolt

16-GAUGE HOLLOW METAL DRYWALL FRAME

(STANDARD DUTY - 4 HINGES)



WIDTH

Nominal Door Width	Rough Opening Width
30"	31½"
32"	33½"
34"	N/A
36"	37½"
42"	43½"
60"	62"
64"	66"
72"	74"

HEIGHT

Nominal Door Height	Rough Opening Height
80"	80¾"
84"	84¾"

- 16-Gauge, A40 Galvanized Steel Construction
- Knock-Down Design
- 18-Gauge Corner Reinforcements to Maintain Proper Miter Alignment
- Built-in Strike Mortised Boxes
- Welded-In Steel Compression Anchors for

Drywall Applications

- Tab and Slot Construction
- 16-Gauge Frames Have Four Hinges
- Strike Jamb Mortised and Reinforced with 18-Gauge Welded-in Reinforcements
- 12-Gauge Hinge Reinforcements on 4" Hinges

- Pre-Finished to Match Door Slab (optional)
- Simple Labor Installation
- Kerfed Stop with Q-Lon Weatherstripping
- Saddle Threshold

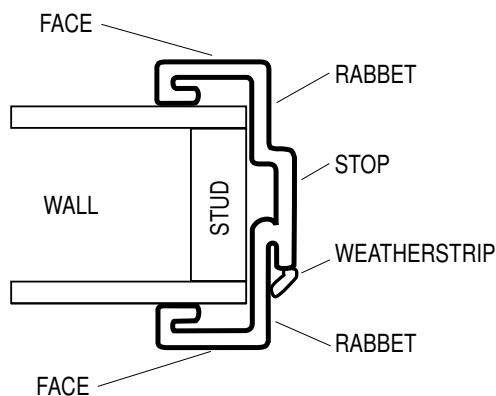

5¾" Jamb Depth 4¾" Throat

FRENCH DOORS

COMMERCIAL BYPASS ASTRAGAL

(Also available with 16-Gauge
Masonry Frame)

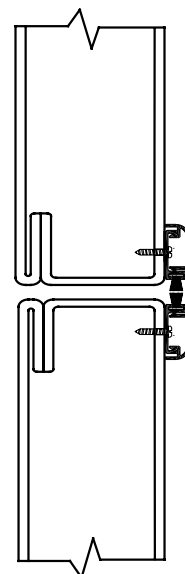

INSTALLATION FRAMES

STEEL FRAMES

18-GAUGE HOLLOW METAL MASONRY FRAME

(LIGHT DUTY - 3 HINGES)



WIDTH

Nominal Door Width	Rough Opening Width
30"	34 $\frac{1}{8}$ "
32"	36 $\frac{1}{8}$ "
34"	38 $\frac{1}{8}$ "
36"	40 $\frac{1}{8}$ "
42"	46 $\frac{1}{8}$ "
60"	64 $\frac{1}{8}$ "
64"	68 $\frac{1}{8}$ "
72"	76 $\frac{1}{8}$ "

HEIGHT

Nominal Door Height	Rough Opening Height
80"	82 $\frac{1}{4}$ "
84"	86 $\frac{1}{4}$ "

- 18-Gauge, A40 Galvanized Steel Construction
- Knock-Down Design
- Built-in Strike Mortised Boxes
- Tab and Slot Construction
- 18-Gauge Frames Have Three Hinges
- 7-Gauge Hinge Reinforcements on 4" Hinges
- 2 x 16 Gauge 2 $\frac{1}{4}$ T Strike Preps 5 $\frac{1}{2}$ Apart for Lockset and Deadbolt
- Pre-Finished to Match Door Slab (optional)
- Simple Labor Installation
- Kerfed Stop with Q-Lon Weatherstripping
- Saddle Threshold

FRENCH DOORS

STANDARD HEAVY DUTY ASTRAGAL

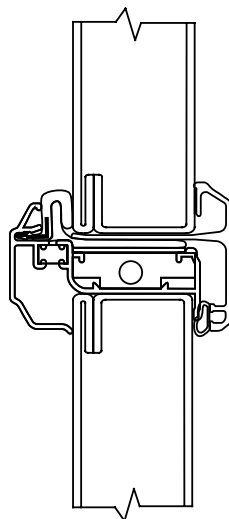
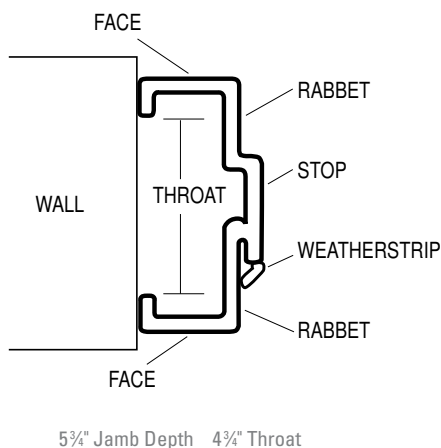

ANCHORS



Masonry T Anchor



Wood or Metal Stud Anchor

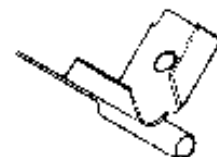

Existing Opening Anchor



Dynabolt

18-GAUGE HOLLOW METAL DRYWALL FRAME

(LIGHT DUTY - 3 HINGES)



WIDTH

Nominal Door Width	Rough Opening Width
30"	31½"
32"	33½"
34"	35½"
36"	37½"
42"	43½"
60"	62½"
64"	66½"
72"	74½"

HEIGHT

Nominal Door Height	Rough Opening Height
80"	80¾"
84"	N/A

- 18-Gauge, A40 Galvanized Steel Construction
- Knock-Down Design
- 18-Gauge Corner Reinforcements to Maintain Proper Miter Alignment
- Built-in Strike Mortised Boxes
- Welded-In Steel Compression Anchors for

- Drywall Applications
- Tab and Slot Construction
 - 18-Gauge Frames Have Three Hinges
 - 7-Gauge Hinge Reinforcements on 4" Hinges
 - 2 x 16 Gauge 2¼ T Strike Preps 5½ Apart for Lockset and Deadbolt

- Pre-Finished to Match Door Slab (optional)
- Simple Labor Installation
- Kerfed Stop with Weatherstripping
- Saddle Threshold

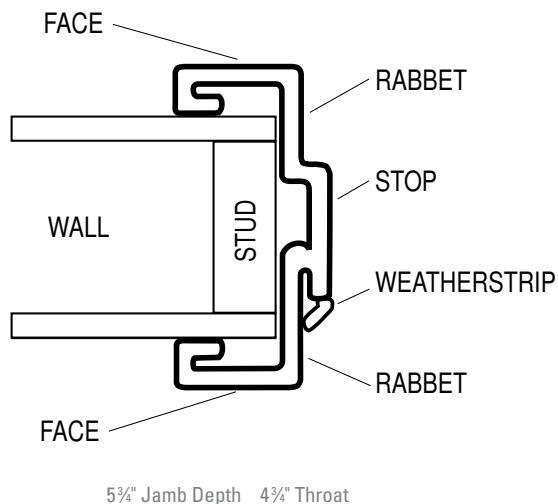

FRENCH DOORS

STANDARD HEAVY DUTY ASTRAGAL

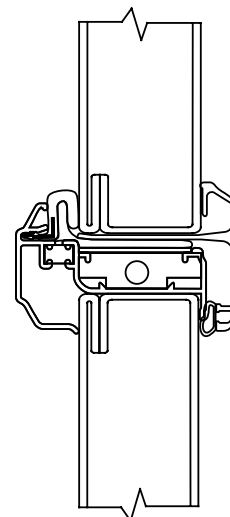

THRESHOLDS

Z-AC™ THRESHOLD

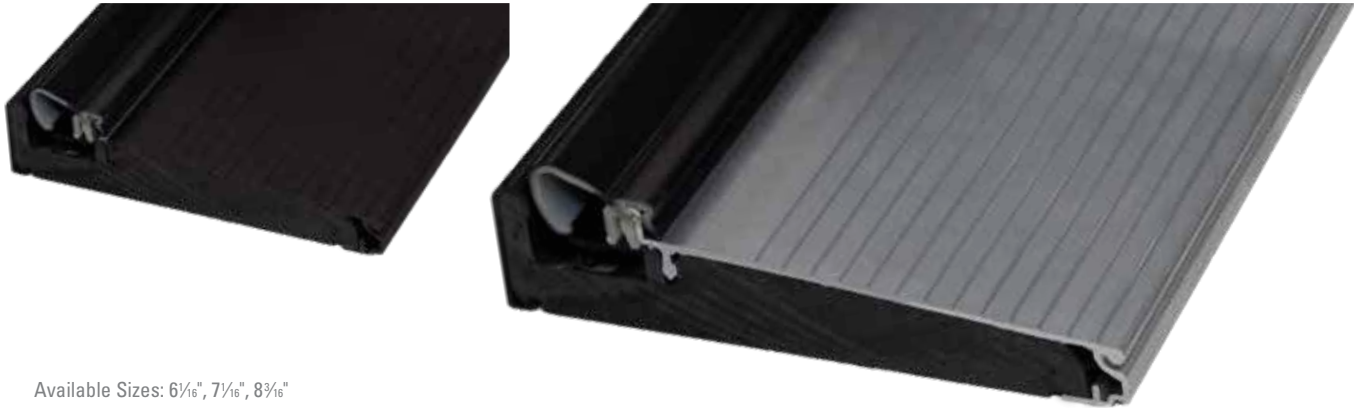

Available Sizes: $6\frac{1}{16}"$, $7\frac{1}{16}"$, $8\frac{3}{16}"$

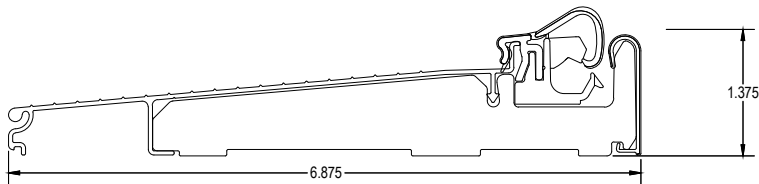

NC OUTSWING THRESHOLD

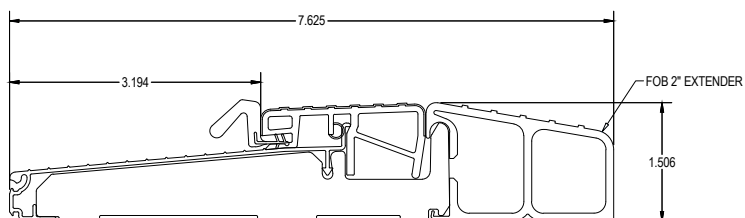

ADA APPROVED 4" SADDLE THRESHOLD

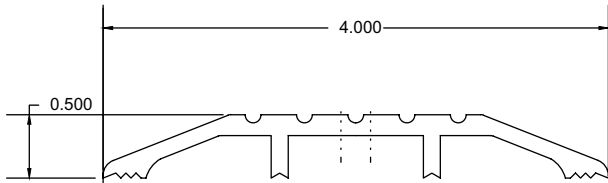

Optional 6" and 8" through special order.

INSWING ADA COMPLIANT THRESHOLD

Available Sizes:
5⁵/₁₆", 6³/₁₆", 7¹/₁₆"



Available in Aluminum (shown) or Bronze finish

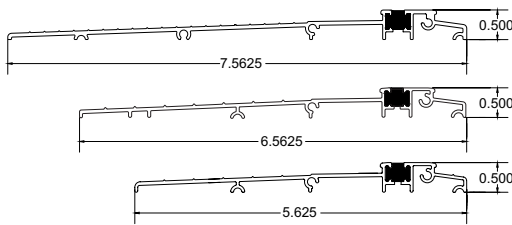

OUTSWING ADA COMPLIANT THRESHOLD

Available Sizes:
5⁵/₁₆" and 7¹/₁₆"



Available in Aluminum (shown) or Bronze finish

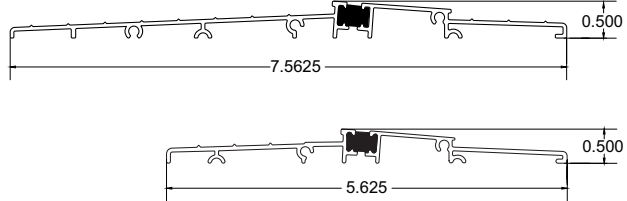

Not Available with Panic Bar with Vertical Rod
Not Available with Removable Mull Post

THRESHOLD AVAILABILITY

	Redi-Flex Steel Frame	18 & 16-Gauge Steel Frame	Full Wood Frame
NC Outswing Threshold	•		•
NC Inswing Threshold	•		•
ADA Compliant 4" Saddle Threshold	•	•	
Inswing ADA Compliant Threshold	•		•
Outswing ADA Compliant Threshold	•		•

STAIN & PAINT FINISHES**

FIBERGLASS STAINS

CHERRY AND MAHOGANY

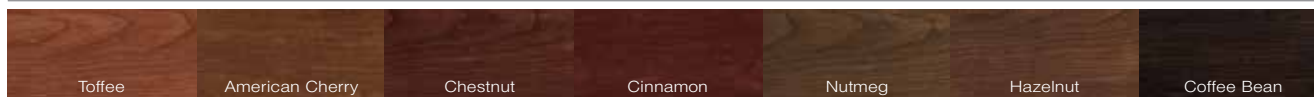

OAK, KNOTTY ALDER AND FIR

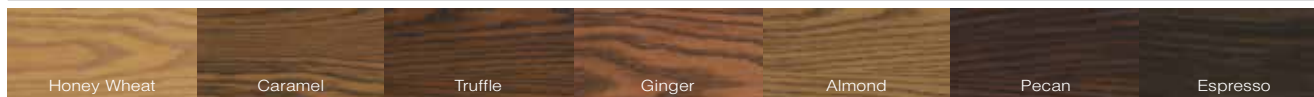

WOODGRAIN TEXTURED STEEL STAINS

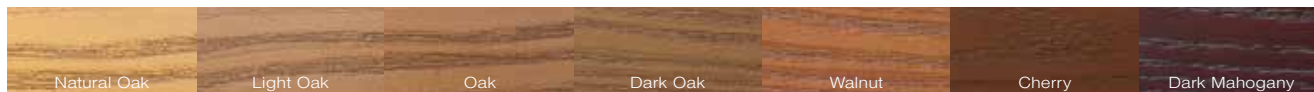

GLAZED FINISHES

FOR FIBERGLASS

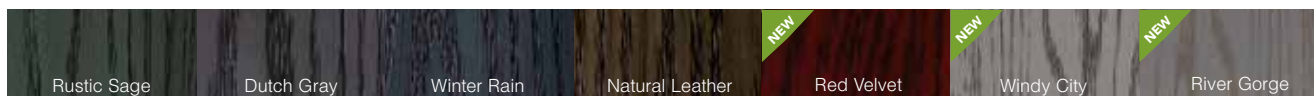

STANDARD PAINT COLORS

FOR ALL FIBERGLASS & STEEL DOORS



ALUMINUM PRE-FIT CLADDING

(MATCHING CAULKING AVAILABLE)

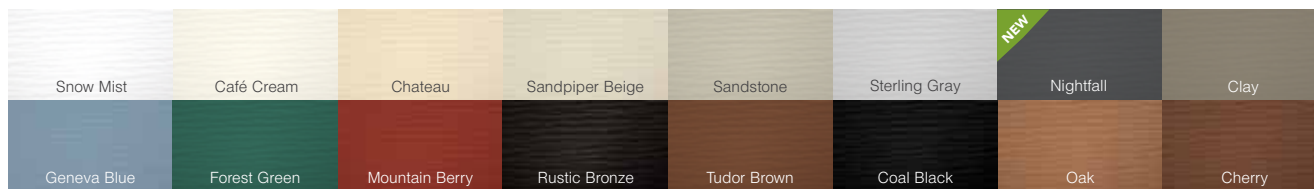

TUFTEX SMOOTH CLADDING ALUMINUM TRIM COIL

WITH MAR-RESISTANT SMOOTH FINISH



◊ Smooth Sandstone cladding is a close match, but not an exact match to Sandstone paint color.

* Smooth Classic Bronze cladding does not match Rustic Bronze cladding color or Rustic Bronze paint color.

**To select color, refer to our color selector for accurate color representation.

TO ORDER CUSTOM PAINT COLORS*

For optimal turnaround, provide your dealer with a Sherwin Williams paint swatch with color name and paint number.

— OR —

Provide your dealer with any brand paint swatch. May add additional lead time.



(3 paint swatches required for Windows and Sliding Patio Doors)

• Homeowner sign-off may be required on custom color match. Refer to entryLINK or contact customer service for details

HARDWARE PREP

PRE-ASSEMBLED BY PROVIA



HARDWARE

SCHLAGE®

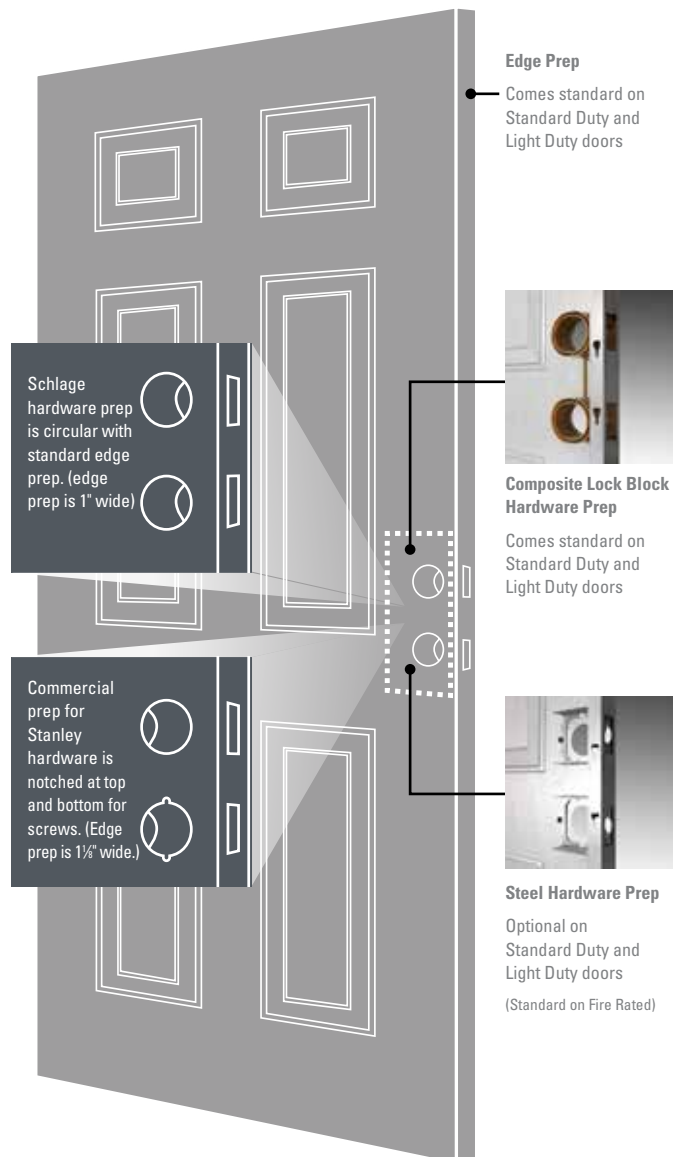

Standard Duty Standard Hardware Prep height is 42" from the floor. Light Duty Standard Hardware Prep height is 34 3/4" from the floor.

Panic Hardware Standard Prep height is 40 3/16" (New Construction Thresholds) to 40 15/16" (ADA Compliant Thresholds) from the floor.

Panic bar height may be lowered to 33 3/8" - 34 5/8" (dependant on threshold) from the floor to avoid interference with embossing or window trim.

ALL SCHLAGE CLASSIC SERIES HARDWARE IS AVAILABLE IN THESE FINISHES

Bright Brass

Antique Brass

Satin Nickel

new Black

SCHLAGE CLASSIC DOOR LOCKSETS & DEADBOLTS

- Deadbolts: Grade 1 BHMA
- Locksets: ANSI/BHMA A156.2, 2011, Grade 2
- Standard Duty / Light Duty



Accent/Addison Keyed Lockset
(not available in Bright Brass)



Accent Keyed Lockset*



Georgian Key in Knob Lockset*



Georgian Key in Knob Lockset
(interior view showing turn lock)*



Latitude Lever with Century Trim Keyed Lockset
(only available in Satin Nickel and Aged Bronze finish)



Latitude Lever with Collins Trim Keyed Lockset
(only available in Satin Nickel finish)



Maximum Security Double Key 1" Deadbolt❖



Addison Trim
(not available in Bright Brass finish)



Maximum Security Interior Only 1-Sided Thumbturn 1" Deadbolt ❖
(Only available in 20-Gauge Steel or Fiberglass with Full Wood Frame)



Century Trim
(only available in Satin Nickel and Aged Bronze finish)



Maximum Security Thumbturn 1" Deadbolt*

❖ Interior Only 1-Sided Thumbturn Deadbolts on any door which is used for egress may be a safety hazard in times of emergency. Double key deadbolts on residences and any door in any structure which is used for egress are a safety hazard in times of emergency.

* Available in Fire-Rated version to meet NFPA Specifications Required on Fire-Rated Doors

STANLEY®

100 SERIES HEAVY DUTY GRADE 1 LEVER LOCKS AND DEADBOLTS

SUMMIT*



SLATE*



* Slate handle is recommended for doors with glass that are half-lite or larger. The window trim will not interfere with the operation of the straight Slate handle.

Slate and Summit Available with Store Room Function - outside lever is always locked. Entrance by key only. Inside lever is always unlocked and free for immediate egress. (For use with electronic strike)

PERFORMANCE FEATURES

- Tested to exceed 1,000,000 cycles, exceeding the 800,000 required to meet Grade 1 certification.
- Standard Clutching Mechanism provides resistance to damage caused by physical force.
- Thru-Bolted design and heavy-duty spring tension provides longer performance life and prevents lever sag.
- Concealed mounting screws.
- Compartmentalized packaging allows for quick and easy installation.



CERTIFICATIONS

- ANSI/BHMA A156.2 Series Grade 1
- ANSI A117.1 Accessibility Code (ADA Compliant)
- UL/cUL Listed (3-hours) for "A" Label Single door applications (4' x 8') (1.219mt x 2.438mt)
- UL10C / UBC 7-2 (1997) Positive Pressure Rated
- California State Reference Code (formerly Title 19 - Fire Marshall)

AVAILABLE FINISHES

626 Satin Chrome

613 Oil Rubbed Bronze

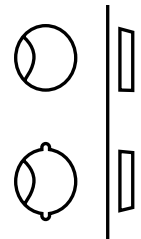

Commercial prep for Stanley hardware is notched at top and bottom for screws. (Edge prep is 1½" wide.)

SINGLE CYLINDER



PERFORMANCE FEATURES

- Tested to exceed 1,000,000 cycles, exceeding the 250,000 required to meet Grade 1 certification.
- Solid forged housing provides enhanced strength and durability.
- Full 1" (25.4mm) throwbolt with saw resistant hardened steel roller pin.
- Anti-drill design - two (2) ball bearings inserted to prevent drill attacks.
- ADA thumbturn.
- Compartmentalized packaging allows for quick and easy installation.



CERTIFICATIONS

- ANSI/BHMA A156.5 Grade 1
- UL/cUL Listed (3-hours) for "A" Label Single door applications (4' x 8') (1.219mt x 2.438mt)
- UL10C / UBC 7-2 (1997) Positive Pressure Rated

AVAILABLE FINISHES

626 Satin Chrome

613 Oil Rubbed Bronze

HARDWARE

STANLEY® PANIC HARDWARE

APEX 2000 SERIES

ALL PANIC HARDWARE IS NOW FACTORY INSTALLED ON THE DOOR

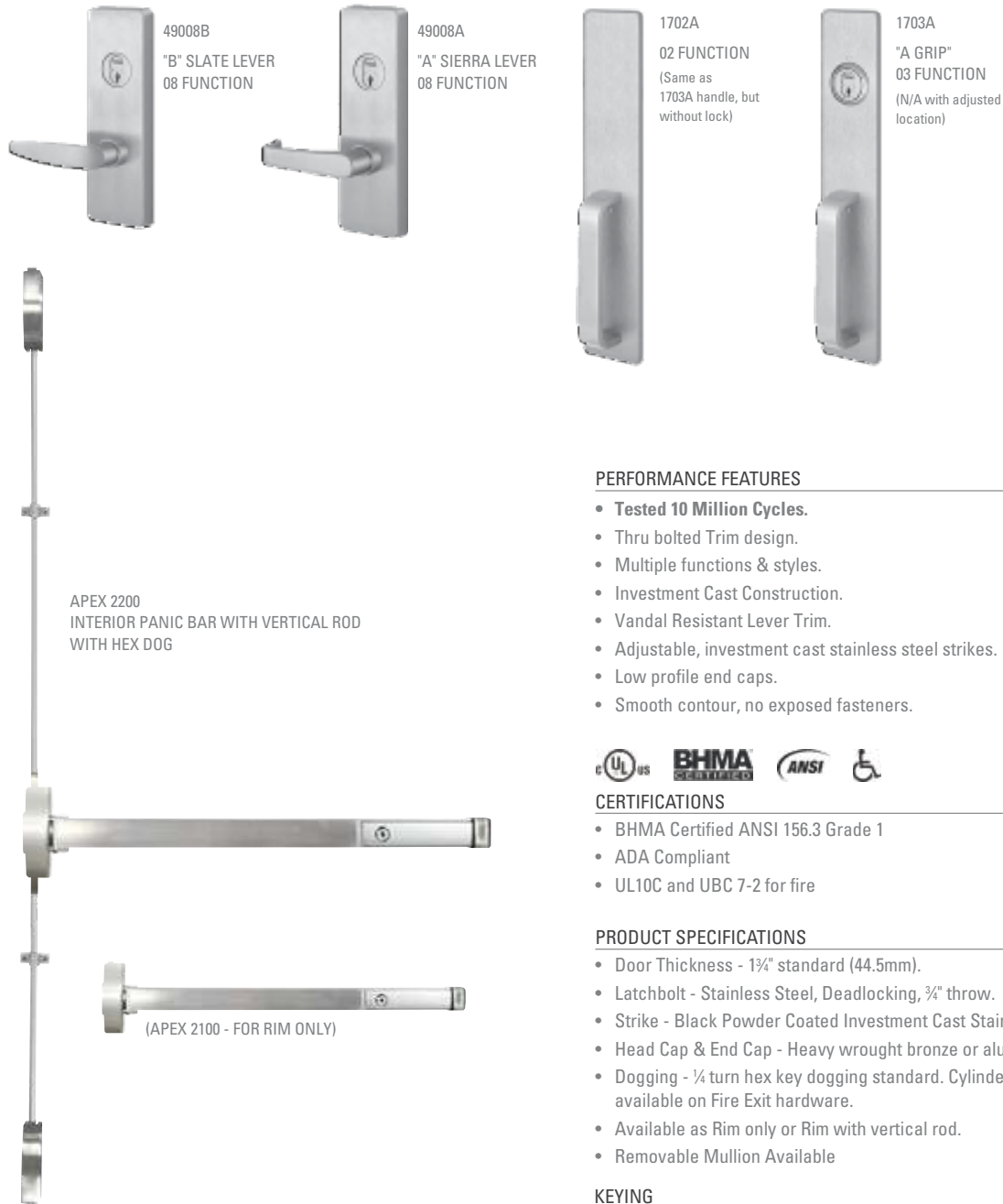

Available Finishes

628 Satin Aluminum

613 Satin Bronze

PERFORMANCE FEATURES

- **Tested 10 Million Cycles.**
- Thru bolted Trim design.
- Multiple functions & styles.
- Investment Cast Construction.
- Vandal Resistant Lever Trim.
- Adjustable, investment cast stainless steel strikes.
- Low profile end caps.
- Smooth contour, no exposed fasteners.



CERTIFICATIONS

- BHMA Certified ANSI 156.3 Grade 1
- ADA Compliant
- UL10C and UBC 7-2 for fire

PRODUCT SPECIFICATIONS

- Door Thickness - 1 1/4" standard (44.5mm).
- Latchbolt - Stainless Steel, Deadlocking, 3/4" throw.
- Strike - Black Powder Coated Investment Cast Stainless Steel.
- Head Cap & End Cap - Heavy wrought bronze or aluminum.
- Dogging - 1/4 turn hex key dogging standard. Cylinder dogging available. NOT available on Fire Exit hardware.
- Available as Rim only or Rim with vertical rod.
- Removable Mullion Available

KEYING

- All exterior handles shown above are standard with Schlage C keyway Cylinder
- Schlage C keyway Cylinder available on panic bar

FUNCTIONS

- 02 - Dummy Trim
- 03 - Outside entrance by pull handle when latch bolt is retracted by key. Door can only be opened when the key is turned. Key removable only when locked (Night Latch).
- 08 - Key locks/unlocks lever.

RELIANT 5000 SERIES



808A
"A" SUMMIT LEVER
08 FUNCTION



RELIANT 5100 INTERIOR PANIC BAR HEX DOG
(N/A on 150, 240, 243, 350, 440, 449, 460 & 112 doors)
Available on 430 with location adjustment only



702A
"A GRIP"
02 FUNCTION



703A
"A GRIP"
03 FUNCTION

PERFORMANCE FEATURES

The Reliant 5000 Series is the Exit Device of choice when an economical and reliable exit device is required. All Reliant 5000 Series Exit Devices are UL listed for panic and fire hardware and are certified to ANSI A156.3 Grade 1. The Reliant Series is available in durable powder coat finishes with a variety of trim styles and functions. The chassis is constructed of stainless steel and covers the standard type 161 door preparation. Tested 500,000 cycles.



CERTIFICATIONS

- BHMA Certified ANSI 156.3 Grade 1
- UL10C and UBC 7-2 for fire

PRODUCT SPECIFICATIONS•

- Door Thickness - 1 3/4" standard (44.5mm).
- Latchbolt -Stainless Steel, Deadlocking, 3/4" throw.
- Strike - Black Powder Coated, Investment Cast Stainless Steel.
- Active Case - Stainless Steel.
- Dogging - 1/4 turn hex key dogging standard. Cylinder dogging available. NOT available on Fire Exit hardware.
- Available as Rim only.
- Removable Mullion Available.

KEYING

- All exterior handles shown above are standard with Schlage C keyway Cylinder
- Schlage C keyway Cylinder available on panic bar

FUNCTIONS

- 02 - Entrance by pull handle when touch bar is dogged down.
- 03 - Outside entrance by pull handle when latch bolt is retracted by key. Door can only be opened when the key is turned. Key removable only when locked (Night Latch).
- 08 - Key locks/unlocks lever.

Available Finishes

689 Aluminum Painted

695 Dark Bronze Painted

HARDWARE

ADDITIONAL HARDWARE OPTIONS

STANLEY® CLOSER



QDC311
TRI-PACK ARM

QDC312
HOLD-OPEN ARM

Available finishes

689 Aluminum Painted

695 Bronze Painted

NORTON® CLOSER



1601

Available finishes

689 Aluminum

690 Bronze

696 Gold

PERFORMANCE FEATURES

- Tested to exceed the performance requirements for Grade 1 certification
- Fully adjustable from 1-6 allowing for maximum flexibility
- Delayed Action and Backcheck are standard in the same door closer body
- All weather oil insures optimal operational performance in multiple climate conditions
- Sized for interior doors to 4'6"; exterior doors to 4' 0"



CERTIFICATIONS

- ANSI/BHMA A156.4 Series Grade 1
- ANSI A117.1 Accessibility Code (ADA Compliant)
- UL/cUL Listed (3-hours) for self-closing doors without hold-open
- UL10C Positive Pressure Rated
- UL10B Pressure Rated

PRODUCT SPECIFICATIONS

- Hanging - All QDC300 Series door closers are non-handed
- Material - Cast aluminum
- Cover - Full, architectural plastic cover option available
- Arms & Brackets - Tri-pack standard (Regular, Top Jamb, Parallel configurations). Hold Open and Dead Stop arms also available.
- Arm Material - Heat treated carbon steel
- Springs - High impact hand drawn steel wires
- Pinions - Heat treated chrome molybdenum steel
- Cylinder construction - Heat treated free-cutting carbon steel
- Fasteners - Wood and machine screws standard

Door Weights & Sizes		Door Width Ranges	
Size	Applicable Door Weight	Interior	Exterior
1	33~55 lbs (15~30 kg)	32"	28"
2	56~99 lbs (30~45 kg)	36"	32"
3	99~143 lbs (45~65 kg)	42"	36"
4	143~187 lbs (65~85 kg)	48"	42"
5	187~264 lbs (85~120 kg)	54"	48"
6	264~330 lbs (120~150 kg)	58"	54"

PUSH / PULL PLATES



PULL ROUNDED*



PUSH/PULL BAR*



KICK PLATE (BLACK/BRONZE)

KICK PLATE ALSO AVAILABLE IN:

SATIN NICKEL

*Special Order

See entryLINK for available finishes.

ELECTRONIC STRIKE PLATE

(For Panic Rim Applications)



9600 SURFACE MOUNTED
HARDWARE

PRODUCT SPECIFICATIONS

- ANSI 250.13-2003 Severe Windstorm listed
- Florida Building Code Approved (FL#14307)
- UL 1034 burglary-resistant listed and suitable for outdoor use
- UL 294 (6th Edition) listed
- ANSI/BHMA, A156.31 Grade 1 (#E09731, #E09732, #E09373)
- RoHS compliant
- Patent # 6,390,520

FRAME APPLICATION

- Metal
- Wood

ELECTRICAL

- .45 Amps at 12 VDC continuous duty
- .25 Amps at 24 VDC continuous duty
- PoE friendly

ELECTRONIC STRIKE PLATE

(For Cylindrical Applications)



5100
VON DUPRIN

PRODUCT SPECIFICATIONS

- Power Failure Mode: Field selectable fail safe/fail secure
- Handing: Non-handed design provides greater flexibility
- Finish: BHMA 689/US SP28 Aluminum Sprayed, BHMA 695/ US SP313 Dark Bronze Sprayed Duranodic, BHMA 622/ US19 Flat Black
- Meets ANSI/BHMA A156.31, Grade 1 for endurance and dynamic strength
- Meets ANSI/BHMA A156.31, Grade 2, 1300 lbs static strength

FEATURES AND BENEFITS

- Designed for cylindrical applications
- Capable of 12 in-field configurations
- Three faceplates standard in every box
- Voltage: Field selectable 24 VDC or 12 VDC
- Non-handed, internal solenoid design
- Field selectable power failure mode (fail-safe/fail-secure)
- Adjustable keeper improves fit on tight door preps
- Options include 12 and 24 VAC to VDC rectifier kits
- Available in three finishes to suite with existing hardware
- Suitable for interior and exterior doors
- UL 1034 listed for burglary-resistant electric door strikes
- Dynamic strength 70 ft-lbs

ELECTRICAL

- 12 VDC continuous duty at .38 amp
- 24 VDC continuous duty at .19 amp

LATCH PROTECTORS



P-HW-ACCSPR-01



EXTERIOR



INTERIOR



LATCH PROTECTOR*



KICKDOWN*



*Special Order

See entryLINK for available finishes.

HARDWARE

FRENCH (DOUBLE) DOORS

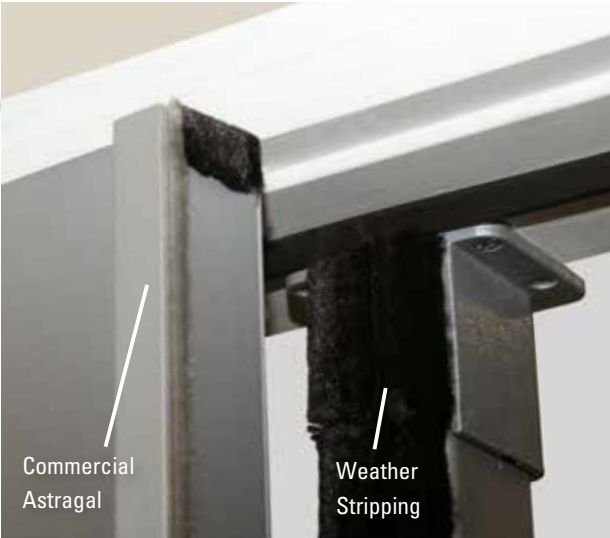

Exterior



Interior View

PANIC BAR HEIGHTS

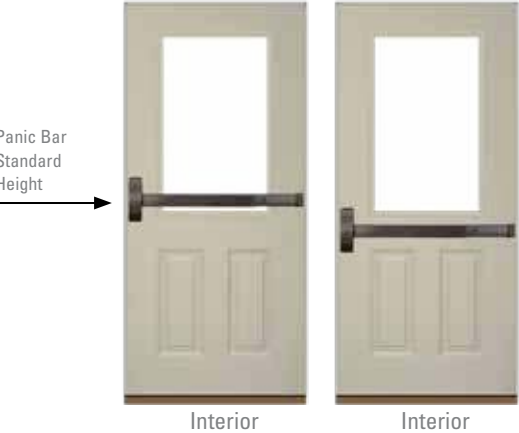

For 430 doors, it is recommended that panic bar and hardware be configured at a lower height to not interfere with window viewing area.

STD. HEAVY-DUTY T-ASTRAGAL - 1 DOOR ACTIVE, 1 INACTIVE



Exterior View



Interior View

STANDARD HEAVY-DUTY ASTRAGAL

- One active, one inactive door
- Must use vertical rod on active door only
- Closer on active door only
- Finish: Painted to Match

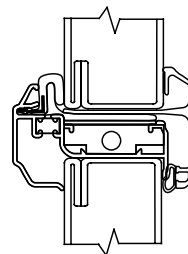

COMMERCIAL BYPASS ASTRAGAL - BOTH DOORS ACTIVE



Exterior View



Interior View

COMMERCIAL ASTRAGAL

(Also available with 16-Gauge Masonry Frame)

- Both doors active
- Must use vertical rod on both active doors
- Closer on both doors
- Finish: Aluminium, Bronze, Gold

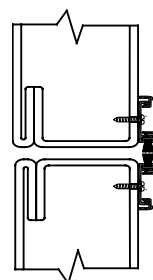

KEY REMOVABLE MULLION - BOTH DOORS ACTIVE



Exterior View



Interior View

KEY REMOVABLE MULLION

(Also available with 16-Gauge Drywall Frame)

- Both doors active
- Can use panic rim
- Closer on both doors
- Finish: Bronze, Silver

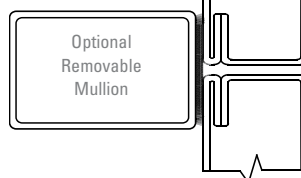

REMOVABLE MULLION
(Available for both Apex and Reliant)

IMAGINE THE POSSIBILITIES

WITH INSPIRATIONS™ ART GLASS



Inspirations Glass is only available from ProVia.



All Inspirations Glass includes our Comfortech Glazing System.

FEATURES

DESIGNS

The process begins with conceptual design. Our beautiful Inspirations Art Glass styles originated from the imagination of our in-house designers.

RESIN BEAD

The design pattern is created on our computer software, and sent to a CNC machine which applies a resin bead to the surface of the glass in one of our four stylish colors.

COLOR FILL

The color fill truly brings the glass to life. Five distinct color palettes are offered empowering you to perfectly reflect the personality of you and your home. Our craftsmen hand-apply this color fill to your glass.



CUSTOM DESIGNS BRING YOUR POSSIBILITIES TO LIFE



If you can dream it, we can build it. Share your one-of-a-kind ideas or logo with ProVia, and allow our designers to customize a distinctive style just for you.



GLASS

FIRE RATED GLAZING



POSITIVE PRESSURE TESTING

In most fires, the extreme heat can cause drafts causing certain amounts of air pressure pushing against a door. In the past, fire codes required only a neutral (negative) fire test. In this test, there was no pressure on the door. This made it easier to pass the test but did not replicate true fire conditions. Today, almost all building codes require fire doors to have a positive pressure rating. Positive pressure testing is conducted in an environment that best replicates those conditions that are present during an actual fire scenario.

20-MINUTE FIRE RATING

- 20-minute label on slab and frame (Full Wood or Composite Frame)
- Fire rated Q-Ion weatherstripping & 2 spring bomber hinges
- Wire glass option
- New Construction or ADA threshold options



90-MINUTE FIRE RATING

- Only available for doors with Hollow Metal Steel Frames or 18-Gauge Redi-Flex Adjustable Steel Frames
- 90-minute label on slab and frame
- Fire rated Q-Ion weatherstripping & 2 spring bomber hinges
- Wire glass option



Wire glass with steel trim 5" x 20" x 1/4" daylight opening size is standard. Other sizes available upon request.

WARRANTY

5-YEAR LIMITED WARRANTY

BASIC DOOR & SIDELITE - 5-YEAR

The Fiberglass, 20-gauge Smooth & Woodgrain Textured Steel door and sidelite slabs are warranted not to shrink, warp, split, crack or delaminate for a period of five (5) years from the date of installation, provided they are installed without alteration and in accordance with applicable building codes.

GLASS UTILIZING SUPER SPACER® - 10-YEAR

Somerset, Carrington, Constance, Esmond, Essence, Symphony, Eclipse, Tacoma, Laurence, Jewel, Gemstone, Florence, Tranquility, Cheyenne, Brilliance, Inspirations™ Art Glass, Barcelona Wrought Iron, Twilight, Taffeta, Chinchilla, Waterfall, Gluechip, Obscure Pebble, glass with Internal Grids, ComforTech™ DLA, TLA, TLK, and Clear glass units are warranted against seal failure and defects in material and workmanship (not including glass breakage) for a period of ten (10) years from date of installation.

DECORATIVE GLASS & INTERNAL BLINDS - 5-YEAR

Decorative glass and internal blind units are warranted against seal failure and defects in material and workmanship for a period of five (5) years from date of installation.

FULL WOOD DOOR FRAME & COMPONENTS - 1 YEAR / 90 DAY

The FrameSaver® Full Wood Frame and brickmold for Doors and Sidelites, and Full Wood Transom Frames are warranted against defects in material and workmanship, and against rotting and decay for a period of one (1) year from date of installation, provided that (i) it is installed without alteration and in accordance with applicable building codes and (ii) all exposed wood parts are protected with an aluminum frame cladding system, installed and caulked as specified by ProVia's installation instructions. For (i) inswing installations where all exposed wood parts are only protected with a quality latex paint topcoat or exterior grade wood stain instead of an aluminum frame cladding system or (ii) an outswing frame, this time period will be limited to ninety (90) days from date of installation. The Endura® threshold system, bottom sweep, hinges, weatherstripping, PVC vinyl coated aluminum frame cladding and the sliding patio screen are warranted against defects in material and workmanship for a period of one (1) year from date of installation.

COMPOSITE FRAME - 1 YEAR

The PermaTech™ Composite Frame and Brickmold for Doors, Sidelites, and Transoms are warranted against defects in material and workmanship, and against rotting and decay for a period of one (1) year from date of installation provided that (i) it is installed without alteration and in accordance with applicable building codes and (ii) it is installed and caulked as specified by ProVia's installation instructions and (iii) there is no storm door installed into the same opening and (iiii) if exterior frame & brickmold are painted, the paint must have a LRV of 57 or higher (where 100 is white and 0 is black).

The terms of this Limited Warranty excludes (i) weathering or discoloring of the unfinished white frame and brickmold and (ii) warping or failures of the frame and brickmold which are the result of or involve stress caused by localized application of heat, movement of building or building components, or expansion/contraction of building or building components.

HOLLOW METAL & REDI-FLEX® STEEL FRAME - 1 YEAR

16 and 18-Gauge Hollow Metal and Redi-Flex® Adjustable Steel Frames are warranted against defects in material and workmanship for a period of one (1) year from date of installation.

FINISHES - 1 YEAR / 90 DAY

Paint and stain finishes on the door slab and metal frame components are warranted against flaking, checking, blistering or peeling for a period of one (1) year from date of installation.

Stain finishes on the exterior components of the Full Wood Frame are warranted against flaking, checking, blistering or peeling for a period of ninety (90) days from date of installation.

STANLEY® COMMERCIAL HARDWARE - LIFETIME / 3 YEAR / 1 YEAR

Stanley® Security Solutions, Inc. products (QCL 100 Series Heavy-Duty Cylindrical Locks, QDB 100 Series Heavy-Duty Deadbolts, QDC 300 Standard Duty Door Closers are warranted against defects in material and workmanship for a limited lifetime for a period of the useful life of the building in which the products are original installed.

Finishes shall be warranted for three (3) years excluding US10B/613 Oil Rubbed Bronze finish.

Electrical products shall be warranted for one (1) year from the date of sale.

This warranty does not cover defects or damage arising from failure to perform normal maintenance, faulty installation, ordinary wear and tear, misuse, abuse, freight damage or application for which the product was not designed.

STANLEY® EXIT DEVICES - 5-YEAR / 3 YEAR / 1 YEAR

Stanley® Security Solutions, Inc. products that are sold under the "PRECISION HARDWARE" trade name (Apex Series, 800 Series Removable Mullions) are warranted against defects in material and workmanship for five (5) years from the date of sale.

Reliant Series are warranted against defects in material and workmanship for three (3) years from the date of sale

Finishes shall be warranted for three (3) years excluding US10B/613 Oil Rubbed Bronze finish.

Electrical products shall be warranted for one (1) year from the date of sale.

This warranty does not cover defects or damage arising from failure to perform normal maintenance, faulty installation, ordinary wear and tear, misuse, abuse, freight damage or application for which the product was not designed.

NORTON® CLOSERS - 15 YEAR

Norton® 1600 Series Door Closers are warranted against defects in material and workmanship for fifteen (15) years from the date of sale.

This warranty does not cover defects or damage arising from failure to perform normal maintenance, faulty installation, ordinary wear and tear, misuse, abuse, freight damage or application for which the product was not designed.

LIFETIME FINISH HARDWARE & ACCESSORIES - 10 YEAR / 1 YEAR

Schlage® Lifetime Finish hardware, Trilennium™ Lifetime Finish Multi-Point Locking Hardware, Emtek® Lifetime Finish hardware, Kick Plates, Mail/Magazine Slots, Door Knockers and Door Knocker Viewers with Lifetime Bright Brass, Satin Nickel and Aged Bronze finish are warranted against tarnishing for a period of ten (10) years from date of installation and warranted against mechanical defects for a period of one (1) year from date of installation. Schlage® Lifetime Finish Keypad Electronic Access Locksets and Deadbolts are warranted against electronic defects for a period of one (1) year from date of installation.

Emtek® handlesets and Colonial Door Knockers with an Oil Rubbed Bronze finish are not warranted against tarnishing.

SCHLAGE® HARDWARE - 1 YEAR

Schlage® lock products with standard finish are warranted against mechanical defects and tarnishing for a period of one (1) year from date of installation.

HARDWARE ACCESSORIES - 1 YEAR

Kick Plates, Mail/Magazine Slots, Door Knockers, Door Knocker Viewers, Peepsites, Decorative Long Trim Handles, and Push/Pull Plates with standard finish are warranted against mechanical defects and tarnishing for a period of one (1) year from date of installation.

WINDOW TRIM - 1 YEAR

Window trim is warranted against defects in material and workmanship for a period of one (1) year from date of installation. This includes doors that are installed behind a storm door.



"To serve, by caring for details in ways others won't." It's not just our mission, but a way of letting our light shine every day at ProVia®. We continually strive to put these words into action by providing unmatched quality and service. The P-icon symbolizes each employee's commitment to devoting the utmost care, pride and quality into each building product we manufacture...it's The Professional Way.



At ProVia, we manufacture energy efficient products and exercise corporate environmental stewardship by recycling, reducing pollution emissions and much more. In fact, our company has received repeated awards from the Environmental Protection Agency such as Partner of the Year - Sustained Excellence for Door and Window Manufacturing.



DOORS | WINDOWS
SIDING | STONE | ROOFING
provia.com

© 2020 ProVia
P-MK-01760-20 | 11/19

Distributed by: